



**Naval Facilities Engineering Systems Command,
Marianas
PSC 455, Box 195
FPO AP 96540-2937**

**MILITARY RELOCATION TO GUAM AND CNMI
PROGRAMMATIC AGREEMENT (PA) MEMO # 1**

Project: Construction of P-316 Artillery Battery Facilities; P-406 Recreation Center; P-408 Religious Ministry Services Facility; P-760 Training Center; P-870 9 th Engineer Support Battalion Training Complex	Date: August 09, 2023 Comment Period Open Until: September 22, 2023
Project Location: United States Marine Corps Base Camp Blaz (MCBCB), Finegayan, Guam	Prepared By: NAVFAC Pacific
PROJECT SUMMARY:	
<p>This submittal is for five proposed “vertical” construction projects: P-316 Artillery Battery Facilities; P-406 Recreation Center; P-408 Religious Ministry Services Facility; P-760 Training Center; P-870 9th Engineer Support Battalion Training Complex (Figure 1).</p>	
<p>The construction is identified in Appendix E of the 2011 <i>Programmatic Agreement among the Department of Defense, the Advisory Council on Historic Preservation, the Guam State Historic Preservation Officer, and the Commonwealth of the Northern Mariana Islands State Historic Preservation Officer Regarding the Military Relocation to the Islands of Guam and Tinian</i> (2011 PA).</p>	
<p>The subject vertical construction projects are located within the J-001B Utilities and Site Improvements (U&SI) project area. The construction location underwent mitigation prior to the J-001B U&SI “horizontal” project, as stipulated by the 2011 PA. The J-001B U&SI project consists of roads, drainage systems, water, wastewater, electrical, communications, security fencing, as well as earthwork activities such as vegetation clearance, grading, cutting/and filling. Concurrent with this work, the Navy is performing additional archaeological efforts consistent with the 2018 resolution agreement with Guam SHPO. Archaeologists will complete these investigations before the construction projects presented in this PA memo begin.</p>	
<p>In accordance with Stipulation IV.E.2.a., this PA Memo presents information to allow the Guam State Historic Preservation Officer (SHPO) and the public to provide comments on the identification and evaluation of historic properties and the finding of effect.</p>	
PROJECT LOCATION:	
<p>All five projects are located within the J-001B U&SI Area of Potential Effects (APE), at MCBCB located at Finegayan, Guam. The projects are on a mostly flat, uplifted limestone plateau. The majority of the interior of the island is comprised of Mariana Limestone.</p>	

1 This PA Memo is required by Stipulation IV.E.2.a. of the PA as a means for interested members of the public to provide comments on the identification and evaluation of historic properties. Stipulation IV.E.1.b. of the 2011 PA requires the DoD to take into account comments received within 45 days of the date of the delivery of this PA memo to the SHPO and public notification via the CRI website.

The project area is located within the village or municipality of Dededo. Although the general area is now commonly referred to as Finegayan or North Finegayan, its pre-World War II name was Machanao.

The APE size for each project is listed below. See Figure 1 for each project and where they are relative to the J-001B U&SI APE.

P-316 Artillery Battery Facilities 8.6 acres

P-406 Recreation Center 2.5 acres

P-408 Religious Ministry Services Facility 1.4 acres

P-760 Training Center 5.9 acres

P-870 9th Engineer Support Battalion Training Complex 9.1 acres

PROJECT DESCRIPTION:

The subject vertical projects propose to construct five facilities. Project efforts include, site preparation, paving and improvements, electrical utilities, and mechanical utilities. Unexploded ordnance, Munitions, and Explosives of Concern (MEC) clearance may also be required.

P-316 Artillery Battery Facilities: This project proposes a two-story Company Battery Headquarters that include administrative offices, conference rooms, electrical/communications maintenance shop and vehicle bays, heavy gun shop and maintenance bays, storage of air or ground organic units, controlled humidity warehouse, restrooms, nursing mother's room, storage rooms, mechanical, electrical and communication spaces. The Company Battery Headquarters consists of reinforced concrete components, such as exterior walls, floors, shallow foundation system of spread and strip footings, beams and pitched; windows; mechanical, electrical and communication systems.

The facility would also build a one-story automotive organizational shop which includes automotive organizational shop and vehicle bays, administrative offices, breakroom, storage, and mechanical, electrical and communications spaces. The automotive organizational shop consists of reinforced concrete components, such as exterior walls, floors, shallow foundation system of spread and strip footings, beams and pitched roof; windows; mechanical, electrical and communication systems.

A one-story heavy gun shop storage would also be constructed. Spaces include heavy gun shop storage, electrical and communications spaces. The heavy gun shop storage consists of reinforced concrete components, such as exterior walls, floors, shallow foundation system of spread and strip footings, beams and pitched roof; windows; mechanical, electrical and communication systems. Construct a one-story vehicle holding shed. Spaces include vehicle bays. The vehicle holding shed consists of reinforced concrete floors, columns, shallow spread footings, beams, and pitched roof.

P-406 Recreation Center: This project proposes construction of a permanent low-rise recreation center with reinforced concrete walls and floor, roof with fluid-applied roofing and concrete shallow foundation. Restrooms and kitchen facilities would be incorporated. A covered outdoor

gathering area and utility support spaces will also be included, along with mechanical, electrical and telecommunications rooms.

P-408 Religious Ministry Services Facility: This project proposes to construct a low rise facility for religious ministry services. Spaces include worship and activity rooms, a kitchen, restrooms, mechanical, electrical and communication spaces. Construction consists of reinforced concrete components such as, exterior walls, floors, shallow foundation system of spread and strip footings, beams and pitched roof, windows, and mechanical, electrical and communication systems.

P-760 Training Center: The project proposes to construct a permanent low-rise structure with reinforced concrete structural frame, walls, floor and roof with fluid-applied roofing and concrete shallow foundation system. Primary facilities consist of a trainer building with operational simulator trainer spaces, applied instruction spaces. private and open offices, server rooms, meeting rooms storage areas and miscellaneous support spaces.

P-870 9th Engineer Support Battalion Training Complex: Proposes to construct training facilities to support III Marine expeditionary force (MEF) 9th Engineer Support Battalion (ESB). Facilities consist of a medium-heavy equipment training area (HE Dig Pit), a water supply training area (UT) and a bulk fuel training area (BF) designed to train personnel in the operation of combat earthmoving equipment, purification of non-potable water and the distribution of bulk fuel (using either fuel or non-potable water). Structures shall be low-rise facilities with slab on grade foundations constructed of concrete with reinforced concrete roofing, windows, mechanical (plumbing) and electrical systems.

The HE Dig Pit is an open pit, filled with soil, that will be utilized for training purposes. The grading and earthmoving training operations require storm water runoff sediment control, as well as dust control. Included within the HE Dig Pit is a tank trap training area for an excavator to perform with a dozer blade.

The UT and BF include a bermed concrete pad which will be used for bulk fuel training with fuel. It will also include a concrete-lined pool to collect rainwater to be utilized for water purification training, as well as provide water for bulk fuel distribution training. The covered training area (bleachers) is a single-story, reinforced, slab-on-grade concrete structure consisting of foundations, roofing, mechanical (plumbing), bleachers and electrical systems.

IDENTIFICATION OF HISTORIC PROPERTIES:

The 2011 PA describes the overall efforts taken to identify historic properties in Stipulation IV, including archival research, oral studies, and interviews. Archaeological surveys have been conducted for the project-specific APEs. Enclosure 1 is list of references for identification efforts in and near the APEs. Regulations do not require survey of an entire APE or identification of all historic properties, and 36 CFR Part 800.4(b)(1) states that a reasonable and good faith effort to carry out appropriate identification efforts shall be made. The 2011 PA directs the PA Memo process to allow for members of the public to provide input on the identification and evaluation of historic properties. The input sought by the process is knowledge on specific historic properties not

yet identified by previous efforts, and feedback on issues relating to effects of the project on historic properties.

Figure 2 illustrates the scope of survey efforts to identify historic properties. Two project locations (P-406 and P-870) overlap areas where previous cultural resources were identified. Those areas have been investigated through the standard mitigation processes established through the 2011 PA prior to completion of J-001B U&SI efforts to fully clear, grub, and grade this area. Consistent with 36 CFR Part 800.4(d)(1), no historic properties are present within the APE, thus denoting a “no historic properties affected” finding.

FINDING OF EFFECT:

As aforementioned, mitigation in accordance with the 2011 PA has been completed for the J-001B U&SI project. The Navy’s ongoing efforts consistent with the 2018 resolution agreement will conclude prior to vertical construction. The DoD finds that the subject construction will have no historic properties affected because while historic properties were identified in the APE, the properties have undergone the agreed upon mitigation processes and are thus no longer extant. Thus, vertical construction will have no effect upon them as defined in § 800.16(i). PA Memo #2 will not be required as there will be no further mitigation.

4 This PA Memo is required by Stipulation IV.E.2.a. of the PA as a means for interested members of the public to provide comments on the identification and evaluation of historic properties. Stipulation IV.E.1.b. of the 2011 PA requires the DoD to take into account comments received within 45 days of the date of the delivery of this PA memo to the SHPO and public notification via the CRI website.

ENCLOSURE 1
REFERENCES

Athens, J.S.

2009 *Archaeological Surveys and Cultural Resources Studies on Guam and the Commonwealth of the Northern Mariana Islands in Support of the Joint Guam Build-Up Environmental Impact Statement* Volume I: Guam. Prepared for Naval Facilities Engineering Command, Pacific Division, Pearl Harbor, Hawaii. International Archaeological Research Institute, Inc. Honolulu, Hawaii.

Church, M., J. Hokanson, J. Gallison, and M. Jennings

2009 *Cultural Resources Survey of 297 Acres at Andersen Air Force Base, Guam*. Prepared for Andersen Air Force Base, Guam. Engineering-Environmental Management, Inc., Englewood, Colorado.

Dixon, Boyd, S. Walker and R. Schaefer

2011 *Cultural Resource Investigations Conducted in the Territory of Guam Supporting the Joint Guam Build-Up Environmental Impact Statement: Final Archaeological Surveys on Guam 2008-2009 at Air Force Barrigada, Proposed Live Fire Training Range, Andersen South, and Naval Base Guam*. Prepared for Naval Facilities Engineering Command, Pacific Division, Pearl Harbor, Hawaii. TEC Inc., Honolulu, Hawaii.

Dixon, B. and S. Walker

2011 *Cultural Resource Investigations Conducted in the Territory of Guam Supporting the Joint Guam Build-Up Environmental Impact Statement: Final Archaeological Surveys on Guam 2009 at Proposed Utility Sites, Harmon Property, and Andersen AFB*. Prepared for Naval Facilities Engineering Command, Pacific Division, Pearl Harbor, Hawaii. TEC Inc., Honolulu, Hawaii.

Dixon, B., T. Rudolph, A. Jalandoni, I. Nelson, M. Hroncich-Conner, S. Leary, R. Schaefer, E. Lash, M. Todd

2015 *Proposed Guam and CNMI Military Relocation 2012 Roadmap Adjustments SEIS Live-Fire Training Range Complex Footprints, Main Cantonment, Utilities, Communications, Well Field Alternatives and Access Route Options* Volume I: Potential Direct Impact Area In-Fill Cultural Resources Study Narrative. Prepared for Naval Facilities Engineering Command Pacific, Pearl Harbor, Hawaii. Cardno TEC, Inc., Honolulu, Hawaii.

Dixon, B., T. McCurdy, R. Shaefer, R. Jones, I. Nelson

2016 *Andersen Air Force Base, Guam, National Historic Preservation Act Section 110 \ Cultural Resources Identification and Evaluation Studies*. Prepared for Naval Facilities Engineering Command Pacific, Pearl Harbor, Hawaii. Cardno TEC, Inc., Honolulu, Hawaii.

Dixon, B., D. Welch, T. Rudolph, R. Jones, and I. Nelson

2018 *Final Technical Report: Archaeological Data Recovery in Support of the J-0001B Utilities and Site Improvements at Naval Base, Guam Telecommunications Site, Guam*. Prepared for Naval Facilities Engineering Command, Pacific Division, Pearl Harbor, Hawaii. TEC Inc. and the University of Guam. (GIS data labeled 2017)

5

This PA Memo is required by Stipulation IV.E.2.a. of the PA as a means for interested members of the public to provide comments on the identification and evaluation of historic properties. Stipulation IV.E.1.b. of the 2011 PA requires the DoD to take into account comments received within 45 days of the date of the delivery of this PA memo to the SHPO and public notification via the CRI website.

Eakin, J., K. Higelmire and D. DeFant

2012 *Archaeological Data Recovery Report Guam Military Relocation MILCON Projects P-100 (North Ramp Utilities) and P-101 (North Ramp Parking), Andersen Air Force Base, Territory of Guam.* Prepared for Department of the Navy, Naval Facilities Engineering Command, Pacific, Pearl Harbor, Hawaii. Southeastern Archaeological Research, Inc. (SEARCH).

Haun, A.E.

1988 *Archaeological Reconnaissance Survey and Field Inspections of Relocatable Over-the-Horizon Radar Sites on Guam, Mariana Islands, Micronesia.* Prepared for Wilson Okimoto and Associates, Inc., Honolulu, Hawaii. Paul H. Rosendahl, PhD, Inc., Hilo, Hawaii.

Highness, D. and A. Haun

1990 *Archaeological Inventory Survey DTS Facility: Barrigada and Finegayan Sites, Dededo and Barrigada Municipalities, Territory of Guam.* Prepared for Belt, Collins, & Associates, Inc., Honolulu, Hawaii. Paul H. Rosendahl, PhD, Inc., Hilo, Hawaii.

Hokanson, Jeffrey H., J. David Kilby, Michael Church and Mary R. McCurdy

2008 *Cultural Resources Survey for a Perimeter Fence and Portions of the Munitions Storage Area, Andersen Air Force Base, Guam.* Prepared for Andersen Air Force Base. Engineering-environmental Management, Inc., Englewood, Colorado.

Kurashina, H., T. McGrath, and H. Manner

1987 *Archaeological Survey of Areas 1, 2, 1-A and 2-A at Northwest Field, Andersen Air Force Base and Naval Communication Area Master Station Western Pacific, Finegayan, Guam, Marianas Islands.* Prepared for Naval Facilities Engineering Command, Pacific, Pearl Harbor, Hawaii. Micronesian Area Research Center, University of Guam, Mangilao, Guam.

Pacheco, T., T. Rieth, and R. DiNapoli

2020 *Archaeological Monitoring in Support of Finegayan Utilities and Site Improvements Phase I, Naval Computer and Telecommunications Station, Guam.* 4 Volumes. Prepared for Department of the Navy, Pacific Division, Naval Facilities Engineering Command, Pearl Harbor, Hawaii. International Archaeological Research Institute, Inc., Honolulu, Hawaii.

Welch, D.

2010 *Archaeological Survey and Cultural Resource Studies Conducted in 2007 on the Island of Guam in Support of the Joint Guam Build-Up Environmental Impact Statement.* 2 volumes. Prepared for Department of the Navy, Pacific Division, Naval Facilities Engineering Command, Pearl Harbor, Hawaii. International Archaeological Research Institute, Inc., Honolulu, Hawaii.

FIGURE 1



Camp Blaz - MILCON Projects - PA Memo - Construction Area

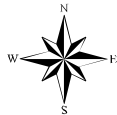
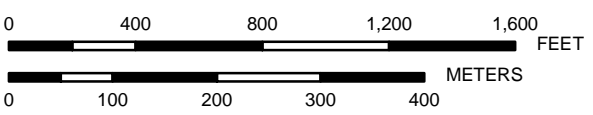

PREPARED BY:
Naval Facilities Engineering Command Pacific Division
Guam Program Management Office



Coordinate System: Geographic
Projection: N/A
Datum: D WGS 1984

Legend

MILCON APE

- P-316 (Artillery Battery) {8.6 ac.}
- P-406 (Recreation Center) {2.5ac.}
- P-408 (Religious Ministry Services) {1.4ac.}
- P-760 (Training Center) {5.9ac.}
- P-870 (Eng. and Bridge Complex) {9.1ac.}

- Sinkhole area not included in the J-001B PA memo (per the 2017 PA memo)
- PA Memo Area J-001B (2014, 2017, 2021)
- J-001B (U&SI) Contract Limits
- Guam Hwys.
- Military Installations

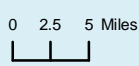

Date: 7/19/2023 Time: 2:47:56 PM Path: C:\Users\laaron.pulliam\OneDrive - US Navy\flankspeed\Documents\GIS Projects\WXDa\Finegayan\EVPA\PA\P316_P406_P408_P760_P859_P870_PA_Memo_CampBlaz_P316_P406_P408_P760_P859_P870_GSHPO - Figure 3.mxd

FIGURE 2

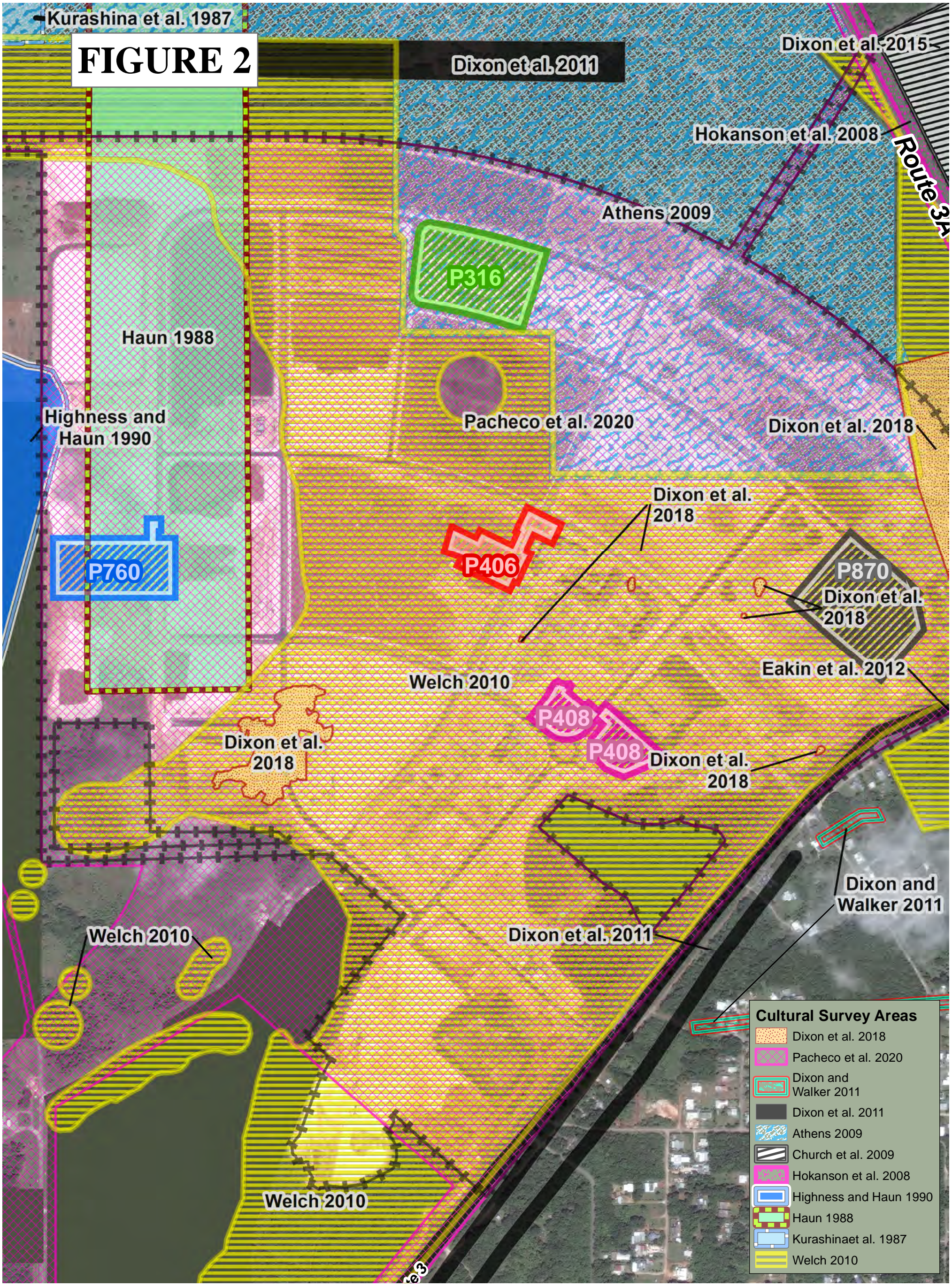

Cultural Survey Areas

[Pattern]	Dixon et al. 2018
[Pattern]	Pacheco et al. 2020
[Pattern]	Dixon and Walker 2011
[Pattern]	Dixon et al. 2011
[Pattern]	Athens 2009
[Pattern]	Church et al. 2009
[Pattern]	Hokanson et al. 2008
[Pattern]	Highness and Haun 1990
[Pattern]	Haun 1988
[Pattern]	Kurashina et al. 1987
[Pattern]	Welch 2010

Camp Blaz - MILCON Projects - PA Memo - Survey Areas

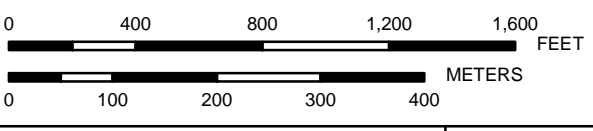

PREPARED BY:
Naval Facilities Engineering Command Pacific Division
Guam Program Management Office
DATE: 19 Jul 2023



Coordinate System: UTM Zone 55 North
Projection: Transverse Mercator
Datum: D WGS 1984

Legend

MILCON APE

- [Green hatched] P-316 (Artillery Battery)
- [Red hatched] P-406 (Recreation Center)
- [Pink hatched] P-408 (Religious Ministry Services)
- [Blue hatched] P-760 (Training Center)
- [Grey hatched] P-870 (Eng. and Bridge Complex)
- [Black outline] J-001B (U&SI) Contract Limits



Military Relocation PA Memo Comment Form

2023

If submitting via **e-mail**, scan and send to: criwebcomment@navy.mil

If submitting via **postal mail**, send to:

Attn: CRI Web Comments
Code EV23, NAVFAC Pacific
258 Makalapa Drive, Suite 100
JBPHH, Hawaii 96860-3134

Submitted comments will be posted on the Navy's Cultural Resources Information (CRI) web site. Information presented on the CRI web site is considered public. The sections highlighted in **red** are required to be completed in order for a comment to be posted.

Privacy Act Statement

Personal information will only be used to contact you regarding the comments you submit. This information will only be shared with another government agency if your inquiry relates to that agency, or as otherwise required by law. We will not create individual profiles or give your information to any private organization. While you must provide a valid e-mail address or postal address, please **DO NOT** include personally identifying information such as a social security number.

By submitting this comment form, you agree not to include content that is offensive in nature, such as profanity, personal attacks on individuals, and racist or abusive language.

PROJECT: Construction of P-316 Artillery Battery Facilities; P-406 Recreation Center; P-408 Religious Ministry Services Facility; P-760 Training Center; P-870 9th Engineer Support Battalion Training Complex

SUBJECT: PA Memo#1

Date: _____

Name: _____

CRI User Name (if you don't want your real name to be posted with your comment on the CRI web site):

E-Mail Address: _____

and/or

Postal Mail Address: _____

COMMENTS: _____
